

SBS Details: D1.7.2-4 Parapets & Copings (Parapet – Wall Transition)

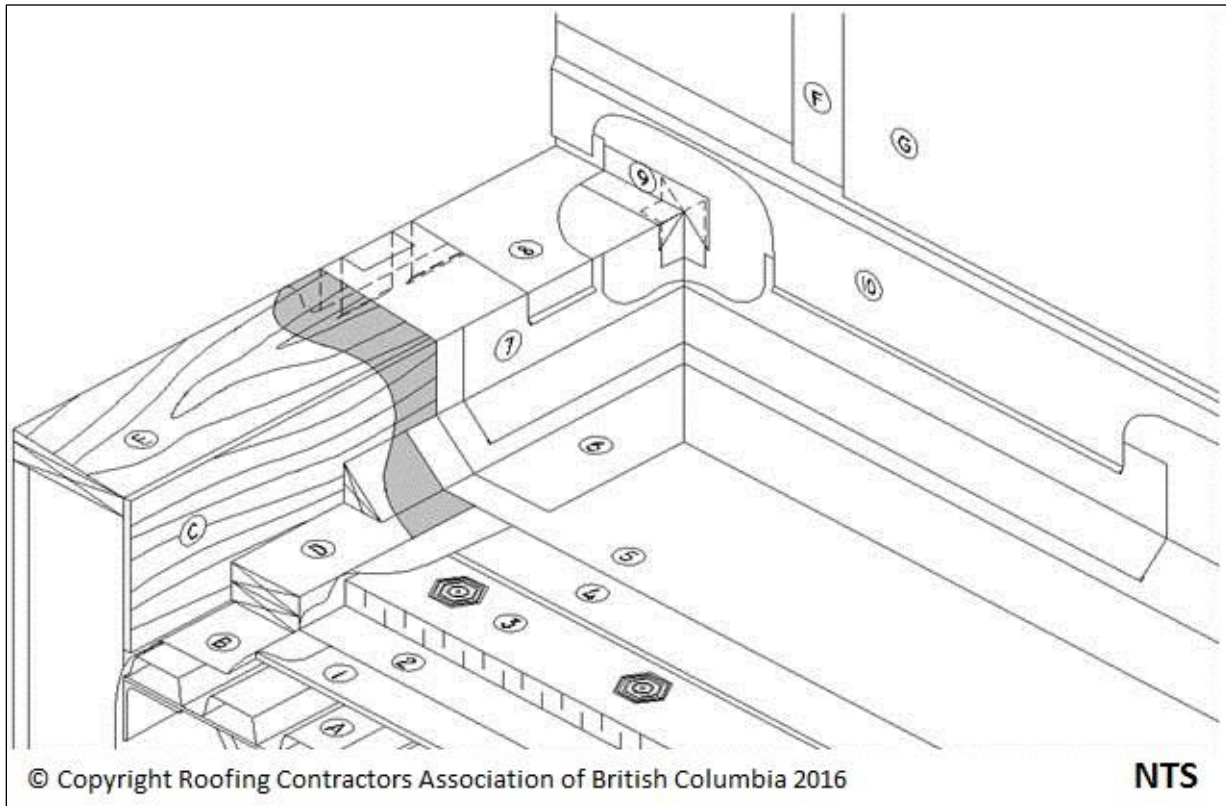

Notice to reader: Drawing for illustration purposes only. Consult the RoofStar Guarantee Standards for more information.

1 WORK INCLUDED

(1) [Gypsum Deck Overlay](#)

If required by design authority.

(2) [Vapour Retarder](#)

If required by design authority.

(3) [Insulation](#)

See list of [Accepted Materials](#).

(4) [Insulation Overlay Board](#)

As required.

(5) [Primary Membrane and Membrane Protection](#)

(6) [Membrane Flashing \(attachment & termination\)](#)

Mechanically fasten at terminations. At least one ply must extend over outside edge.

(7) [**Metal Base Flashing**](#)

Optional on flexible membrane systems. Required on assemblies using gravel ballast filter mats.

(8) [**Metal Cap Flashing**](#)

Must overlap exterior wall finish. Fasten with concealed clip-type fasteners or cladding screws evenly spaced between seams.

(9) [**Wall Tie-in**](#)

Minimum 2 mm (0.078") self-adhered modified bitumen or flexible membrane manufacturers approved detail.

(10) [**Metal Counter-flashing**](#)

2 RELATED WORK BY OTHERS

(A) [**Acceptable Deck**](#)

(B) [**Air/Vapour Seal**](#)

(C) [**Acceptable Wall Surface**](#)

(D) [**Wood Blocking**](#)

(E) [**Sloped Wood Blocking**](#)

Required over 100 mm (4") parapet width.

(F) [**Wall Sheathing Membrane**](#)

Minimum 1 mm (0.040") self-adhered modified bitumen.

(G) **Wall Cladding**